

# histen

Valve & Fitting Solution

STAINLESS STEEL FITTINGS

COUPLING

SNAP TAP WITH SADDLE

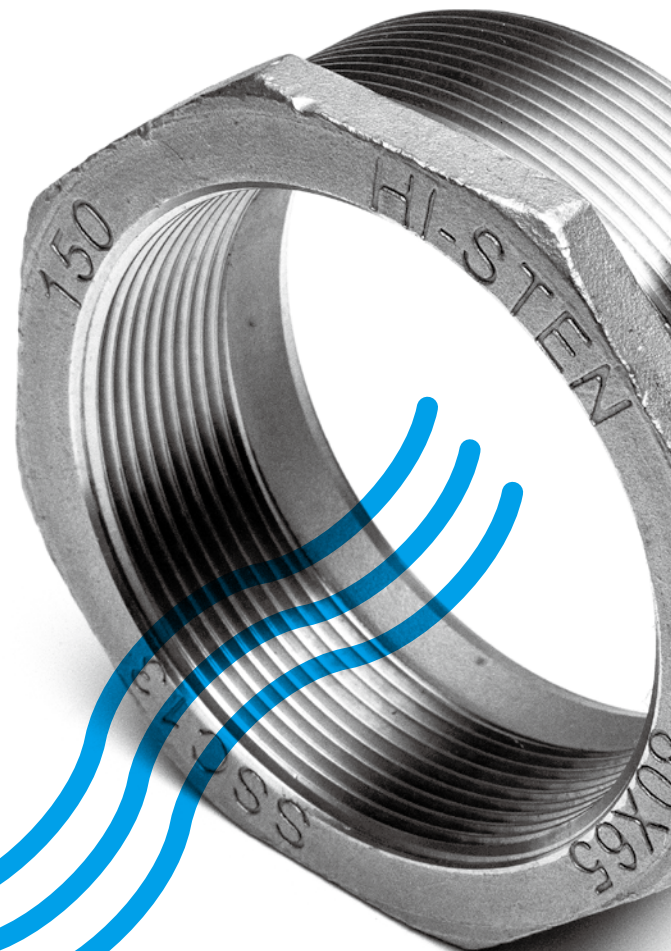

HISTEN CORPORATION  
SINCE 1994

## About us

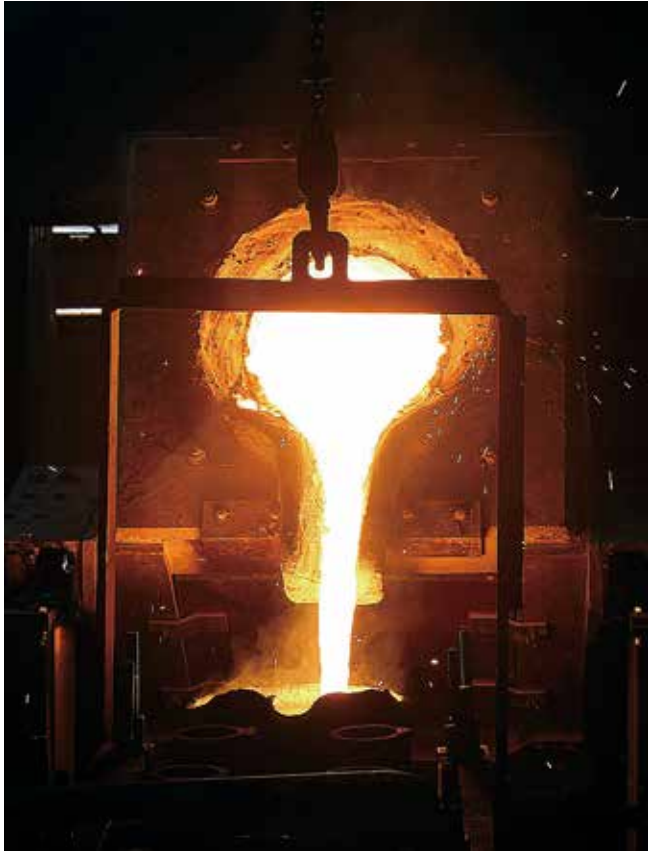

Established in 1994, HISTEN Corporation has been supplying only reliable and safe products to homes and various industrial fields including government authority projects as a certified manufacturer of Stainless steel valves, Mechanical joints and Fittings.

Our company has independent facility lines for Casting, Machining, Assembly, Test and Inspection, Solution heat treatment and a R&D center to control and guarantee the quality of products.

Products manufactured from HISTEN are mainly based on casting, and a unique solution heat treatment method is applied to maximize the corrosion resistance.

Our innovative technology on products started from efforts to minimize the leakage, corrosion and pipe breakaway under severe conditions such as earthquakes, ground subsidence and any external forces after installation.

Moreover, HISTEN performs all the procedures required to produce one product, from selecting the raw materials to inspecting the final product under strict supervision and control in accordance with international codes and standards and HISTEN standards.

These efforts and developments for decades resulted in HISTEN winning many awards from the government and

other public authorities with a good reputation for excellent quality.

Now, HISTEN Corporation is expanding its business area into other diverse industries including oil and gas, chemical, marine, power generation with new technology and materials.

To satisfy all of our customers' needs, HISTEN started an OEM service for all products according to the Client's specifications or requirements.

We will continue to focus on achieving the greater customer satisfaction in Quality, Price and Delivery.

## Vision

**Best Solution for Leakage, Corrosion and Pipe Breakaway!**  
**Best Application for safe piping and fluid transfer!**

HISTEN Corporation will remain an honest manufacturer providing only reliable and safe product for a better life.

## Customer

### • Company



### • Public Government



- More than 63 Government Offices use

# STAINLESS STEEL FITTINGS

## Application

- All stainless steel pipes.
- Hot and Cold water pipeline for industries, Fire water lines and waterworks.
- Temperature range :

Type	Elbow, Tee, Socket, Nipple, Plug, Cap, Bushing	Union, MF Union, Union Elbow, Water Tank Fitting with PTFE Packing	Union, MF Union, Union Elbow, Water Tank Fitting with EPDM Packing
Temperature range	-20 ~ 200°C	-20 ~ 130°C	-20 ~ 100°C

- Pressure Range : 10bar (Maximum operating pressure : 20bar).
- Custom made available (size, material, standard, industries and etc.).

## Components and materials

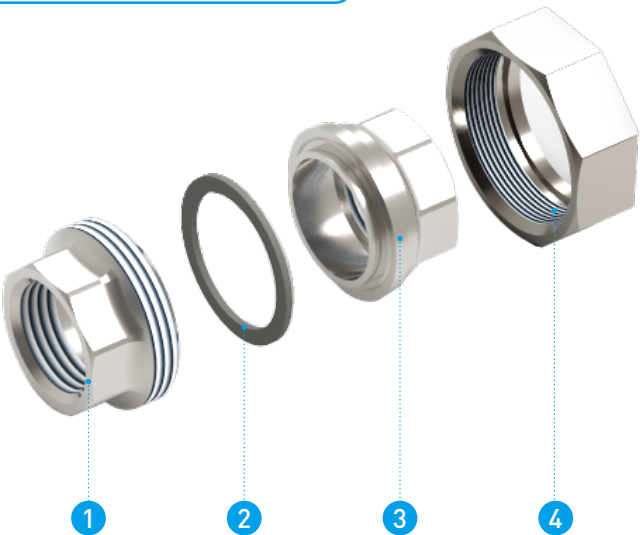

NO.	COMPONENT	MATERIAL
1	Thread	CF8 / CF8M
2	Gasket	EPDM / PTFE
3	Seat	CF8 / CF8M
4	Nut	CF8 / CF8M
Type	Union, MF Union, Union Elbow	

## Features

- Made of stainless steel.
- High resistance for corrosion and contamination.
- Secure sealing by precision machining on thread.
- Solution heat treatment applied.





Product types and sizes

Type			
	ELBOW	TEE	UNION
Size	DN6, DN8, DN10, DN15, DN20, DN25, DN32, DN40, DN50, DN65, DN80, DN100		
Type			
	PLUG	HEX NIPPLE	45° ELBOW
Size	DN6, DN8, DN10, DN15, DN20, DN25, DN32, DN40, DN50, DN65, DN80, DN100		DN8, DN10, DN15, DN20, DN25, DN32, DN40, DN50
Type			
	STREET ELBOW	SOCKET	END CAP
Size	DN6, DN8, DN10, DN15, DN20, DN25, DN32, DN40, DN50		DN10, DN15, DN20, DN25, DN32, DN40, DN50, DN65, DN80, DN100

## Product types and sizes



Type				
	HOSE NIPPLE	REDUCING ELBOW	REDUCING TEE	
Size	1/8" x DN5~13, 1/4" x DN8~13, 3/8" x DN8~16, 1/2" x DN8~20, 3/4" x DN13~25, 1" x DN20~33, 1-1/4" x DN33, 1-1/2" x DN40.5, 2" x DN52.5	DN15 x 10, DN20 x 15, DN25 x 15, DN25 x 20, DN32 x 15, DN32 x 20, DN32 x 25, DN40 x 20, DN40 x 32, DN50 x 40, DN40 x 15, DN40 x 25, DN50 x 15, DN50 x 20, DN50 x 25, DN50 x 32	DN10 x 8, DN15 x 8, DN15 x 10, DN20 x 10, DN20 x 15, DN25 x 15, DN25 x 20, DN32 x 15, DN32 x 20, DN32 x 25, DN40 x 15, DN40 x 20, DN40 x 25, DN40 x 32, DN50 x 15, DN50 x 20, DN50 x 25, DN50 x 32, DN50 x 40	
Type				
	REDUCING SOCKET	BUSHING	REDUCING NIPPLE	
Size	DN8 x 6, DN10 x 8, DN15 x 8, DN15 x 10, DN20 x 10, DN20 x 15, DN25 x 15, DN25 x 20, DN32 x 15, DN32 x 20, DN32 x 25, DN40 x 15, DN40 x 20, DN40 x 25, DN40 x 32, DN50 x 15, DN50 x 20, DN50 x 25, DN50 x 32, DN50 x 40, DN65 x 50, DN80 x 50, DN80 x 65, DN100 x 80		DN10 x 8, DN15 x 10, DN20 x 15, DN25 x 15, DN25 x 20, DN32 x 15, DN32 x 20, DN32 x 25, DN40 x 15, DN40 x 20, DN40 x 25, DN40 x 32, DN50 x 15, DN50 x 20, DN50 x 32, DN50 x 40, DN50 x 25	
Type				
	UNION ELBOW	CROSS TEE	MF UNION	FITTING FOR WATER TANK
Size	DN15, DN20, DN25, DN32, DN40, DN50			

# PIPE NIPPLES



## Features

- Made of Stainless Steel Pipe above schedule 20.
- Secure sealing by precision machining on thread.
- High resistance for corrosion and contamination.
- Thread type and Pipe length are adjustable.

## Product types and sizes

Type			
	Pipe Nipple(TOE)-Short	Pipe Nipple(TOE)-Medium	Pipe Nipple(TOE)-Long
Size	DN8, DN10, DN15, DN20, DN25, DN32, DN40, DN50, DN65, DN80, DN100		

Type			
	Pipe Nipple(TBE)-Short	Pipe Nipple(TBE)-Medium	Pipe Nipple(TBE)-Long
Size	DN8, DN10, DN15, DN20, DN25, DN32, DN40, DN50, DN65, DN80, DN100		

# COUPLING

## Application

- All types of pipes for water supply lines or various industries.
- Used for connection between pipes or emergency repair of pipe-lines.
- Temperature Range : -20 ~ 100°C.
- Pressure Range : 10bar (Maximum operating pressure : 20bar).
- Custom made available (size, material, standard, industries, etc.).

## Components and materials

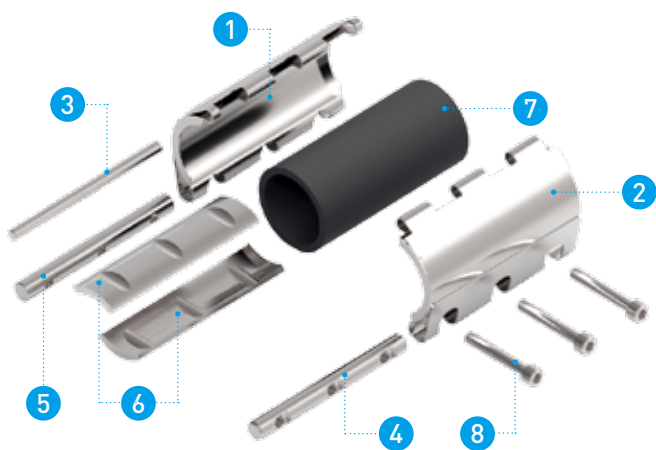

NO.	Component	Material
1	Casing-L 25L	SUS304 / SUS316
2	Casing-L 25R	SUS304 / SUS316
3	Locking Bar-L 25S	SUS304 / SUS316
4	Locking Bar-L 25L	SUS304 / SUS316
5	Locking Bar-L 25Nut	SUS304 / SUS316
6	Casing-L 25S	SUS304 / SUS316
7	Packing-L 25	EPDM
8	CB6_40	SUS304 / SUS316
Type	Hinge-Long	

## Features

- HISTEN Couplings are designed to maximize flow with minimum pressure loss.
- Stainless steel body with High quality sealing materials and optimized design prevent fluid leakage.
- Easy and quick installation for general piping application or emergency repair.
- Various rubber packing materials are applicable in accordance with different fluids and conditions.
- No welding, no heavy tools required, and can be applicable to various pipe materials.



## Product types and sizes

Type			
	GRIP-S	GRIP-L	FLEX-S
Size	DN15, 20, 25, 32, 40, 50, 65, 80, 100, 125, 150, 200, 250, 300, 350		DN15, 20, 25, 32, 40, 50, 65, 80, 100, 125, 150, 200, 250, 300, 350, 400, 450, 500, 550, 600, 650, 700, 750, 800, 850, 900, 1000

Type			
	FLEX-L	DOUBLE-S	DOUBLE-L
Size	DN15, 20, 25, 32, 40, 50, 65, 80, 100, 125, 150, 200, 250, 300, 350, 400, 450, 500, 550, 600, 650, 700, 750, 800, 850, 900, 1000	DN20, 25, 32, 40, 50, 65, 80, 100, 125, 150, 200, 250, 300, 350, 400, 450, 500, 550, 600, 650, 700, 750, 800, 850, 900, 1000	DN25, 32, 40, 50, 65, 80, 100, 125, 150, 200, 250, 300, 350, 400, 450, 500, 550, 600, 650, 700, 750, 800, 850, 900, 1000

Type		
	HINGE-S	HINGE-L
Size	DN15, 20, 25, 32, 40, 50, 65, 80, 100, 125, 150, 200, 250, 300, 350, 400, 450, 500	DN15, 20, 25, 32, 40, 50, 65, 80, 100, 125, 150, 200, 250, 300, 350, 400, 450, 500, 550, 600, 650, 700, 750, 800, 850, 900, 1000

# SNAP TAP WITH SADDLE

## Application

- All types of water supply main pipes.
- Use for building branch pipes off from main pipeline without locking water supply.
- Temperature Range : -20 ~ 100°C.
- Pressure Range: 10bar (Maximum operating pressure : 20bar).
- Custom made available (size, material, standard, industries, etc.).

## Components and materials

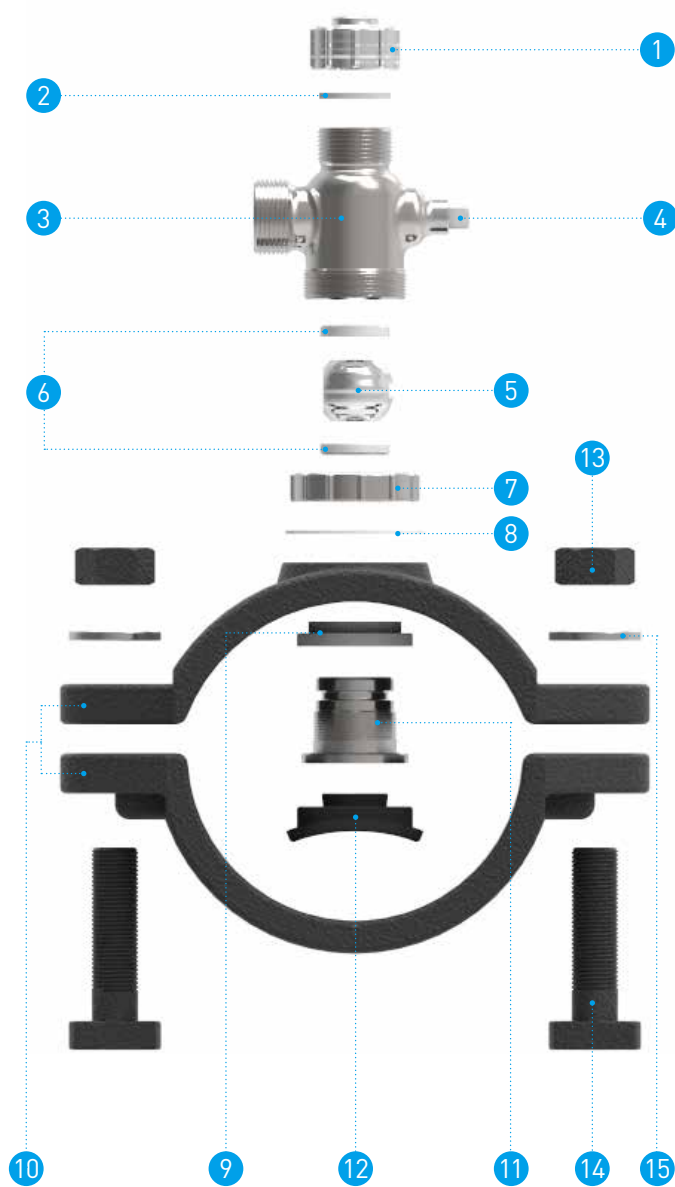

NO.	Component	Material
1	Cap	CF8 / CF8M
2	Cap Packing	EPDM
3	Body	CF8 / CF8M
4	Stem	SS304 / SS316
5	Ball	SS304 / SS316
6	Seat	PTFE
7	Lock Nut	CF8 / CF8M
8	Insulation Pad	P E
9	Insulation Guide	PE / EPDM
10	Saddle & Band	FCD450
11	Insert	CF8 / CF8M
12	Upper Packing	EPDM
13	Nut	FCD450
14	Bolt	FCD450
15	Washer	SS400

## Product types and sizes



Type		CIP (PE Pipe)	VP (Ductile Pipe)
Size	Saddle Band	DN75, DN100, DN150, DN200, DN250, DN300, DN350	DN40, DN50, DN75, DN100, DN150, DN200, DN250, DN300, DN350
	Snap Tap	DN13, DN20, DN25, DN30, DN40, DN50	DN13, DN20, DN25, DN30, DN40, DN50

## Features

- Designed as 360° free swivel, maximize convenience to adapt at construction site.
- Double block packing design prevents leakage from the connection points between saddle and main pipe.
- Anti-corrosion technology applied to prevent a galvanic corrosion between ductile saddle and stainless steel valve.
- Build up branch pipes from main pipeline without locking water supply due to control ball in the body.
- Solution heat treatment applied stainless steel valve.

## Installation guide



Install the Saddle on the main pipe



Drill a hole on the main pipe through the snap tap



Connect the branch pipe from the snap tap

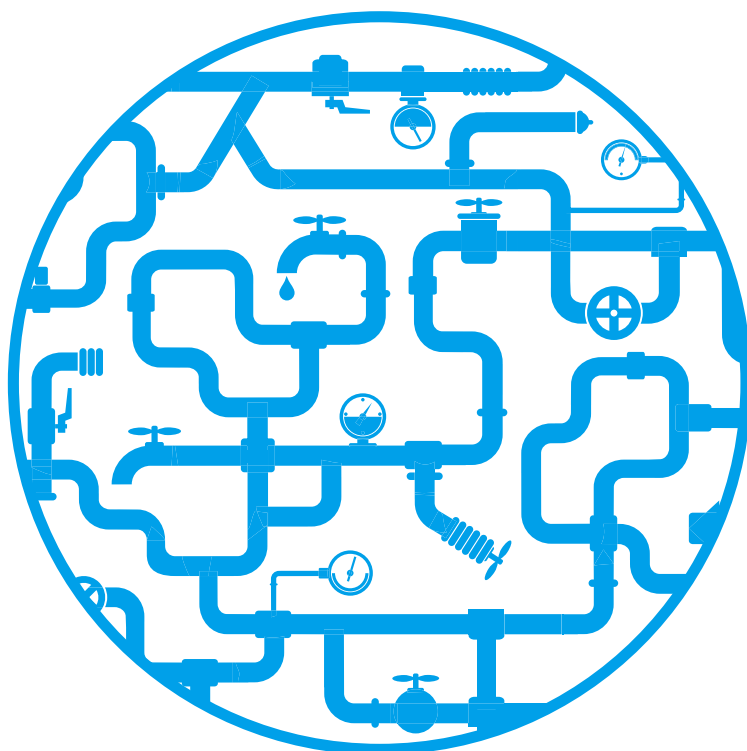

## HI-STEN Co., Ltd

113-79, Seoburo 1499beon-gil, Gimhae-si, Gyeongsangnam-do, Korea

Tel. +82-55-328-0840, +82-55-329-0837 | Fax. +82-55-329-0841 | E-mail. [histen\\_id@histen.co.kr](mailto:histen_id@histen.co.kr)

[www.histen.co.kr](http://www.histen.co.kr)



CAUTION

- Descriptions, values and specifications in the catalog do not mean to guaranteeing the product quality itself.
- All products to be installed in accordance with current HISTEN installation instructions and application guide.
- HISTEN reserves the right to change the specifications, designs and standard equipment without notice and without incurring obligations.